

Bog #319 on Mill Brook Ridge, SSE of Kelly Hollow

with Rich Parisio 6/2/97

Bog initially discovered Sept '96 with Michael DeWan + David Samuels (see p. 270-29)

270-33

Site	P	Ap	Se	e calc	e map	time	rate
(A) Mill Brook Road at Kelly Hollow trail head	29.85	0.00	—	—	1770	10:25 AM	
(B) upper trail bridge	29.50	0.35	346	2110		11:00	$3120 - 1770 = 1350'$
(C) stone wall = (K?)	29.26	0.59	573	2343		11:12	$29.85'' - 29.46'' = 1.39''$
(D) log road	29.18	0.67	651	2421			
(E) P-brainii	29.13	0.72	699	2469			$V = \frac{1350}{1390} = 0.971$
(F) log road	28.98	0.87	845	2615			
(G) stump	28.94	0.91	884	2654			
(H) 10' high boulder	28.62	1.23	1194	2964			
(I) COL: Bog #319	28.46	1.39	1350	—	3120	12:20 PM 1:35	
(J) Stumps	28.68	1.22	1144	2914			$3120 - 1770 = 1350'$
(K) stone wall = (C?)	29.28	0.62	582	2352			$29.90'' - 28.46'' = 1.44''$
(L) stone wall	29.45	0.45	422	2192			
(M) on trail, upper bridge	29.52	0.38	356	2126		2:35	$V = \frac{1350}{1440} = 0.938$
(N) Trail head	29.90	0.00	—	—	1770	3:10 PM	

e-p 254 at 3115'

27034

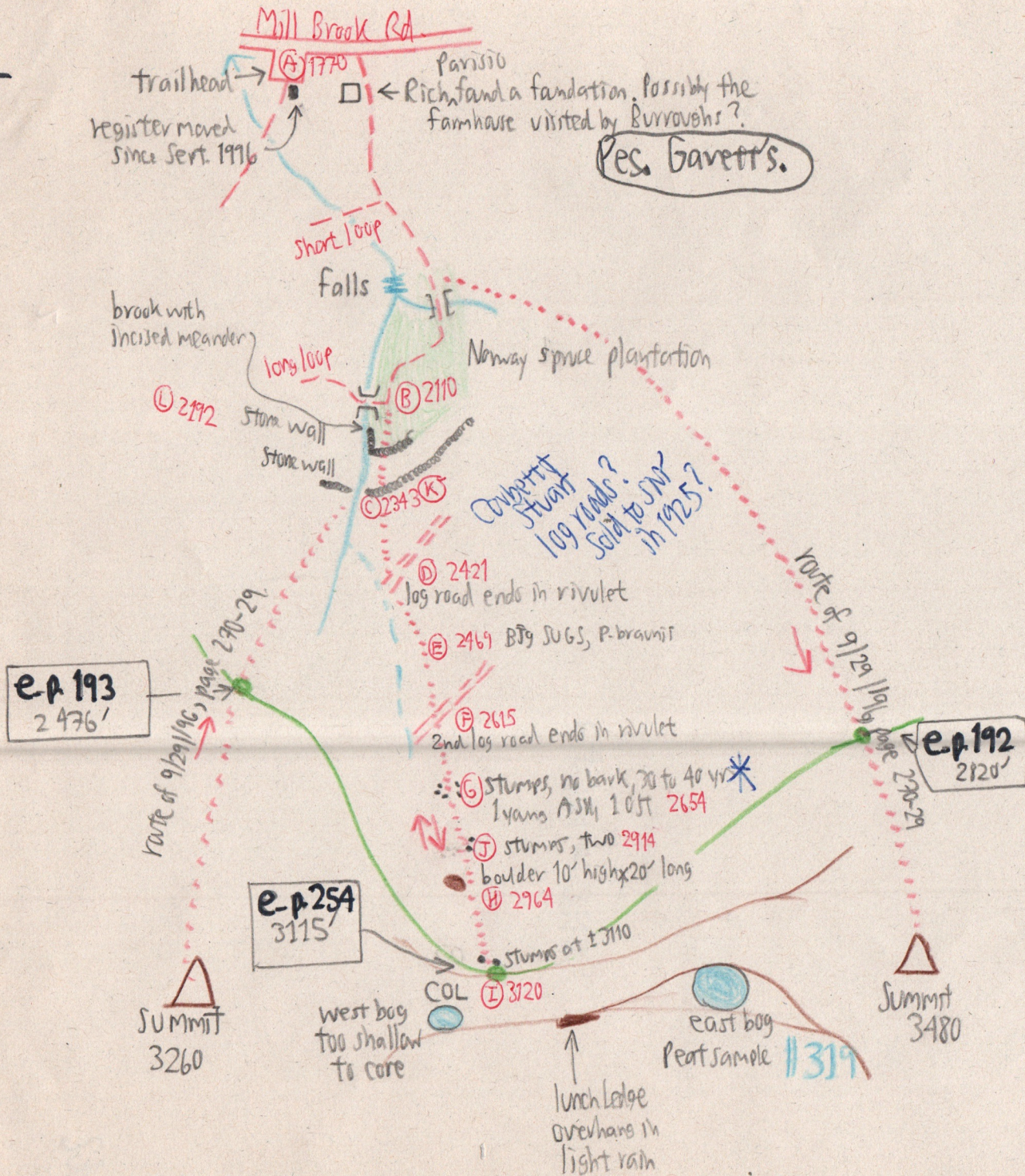

Flora of Col at (I):
 BC dom, B, RM
 ERY, \$, UVUL abun, OX
 STREET, RS, AA, MC, TE, CB

Flora of covered bog:-
 CIMN dom (described by
 Burroughs as
 "shoulder high?")
 VV
 \$
 COPTIS
 ERY
 RM-YB

24" to silt. Peat
 sample 22" to 24"

Age = 7500 ± #319
 years
 Twig of fir at bottom.

* Can't be this recent unless a trespass.
 Lot 51 was acquired in 1925.
 Could these be Covberrtt Stuart Stumps?
Yes, if YB
 - 4/11/13